

SL

Standard Slotter Chuck (Hard Jaws)

- Standard slotter chuck with solid jaw (incl. internal and external hard jaws)

SLOTTER CHUCK

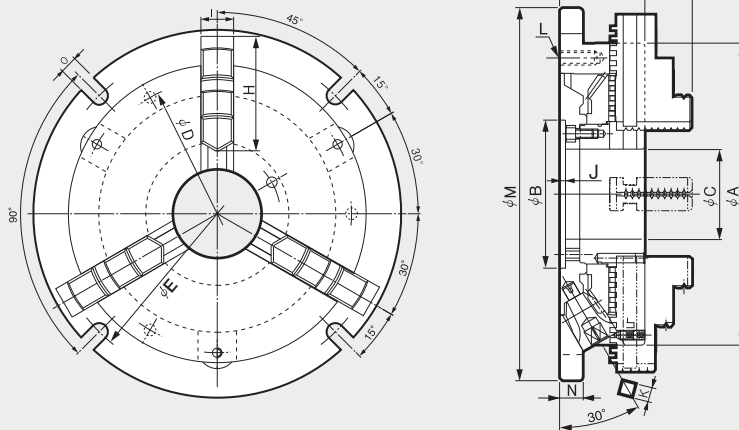

Dimensions

	φA	φB(HC6)	φC	φD	φE	F	G	H	I	J	K	L	M	N	O
SL-08	215	110	60	190.5	240	35.04	64	85	25	4	11	M10	266	17	13
SL-10	255	125	76	230	286	40.02	72	98	28	4.5	12	M12	315	20	15
SL-12	305	160	100	280	340	45.05	76	110	30	5	14	M12	370	22	17

Specifications

Type	Max. Static Gripping Force.	Clamping Range		Handle Torque	Weight
	kN(kgf)	External (φmm)	Internal (φmm)	[N·m(kgf·m)]	[kgf]
SL-08	37(3,800)	4-182	58-174	117.7(13)	17.6
SL-10	46(4,700)	4-220	68-212	176.5(18)	27.7
SL-12	55(5,620)	5-266	80-263	196.2(20)	40

※ Specifications are subject to change without notice.