

- Pulled down to location for accuracy
- Collet changes quickly for machining a variety of work pieces
- Air sensing can be added for automatic loading

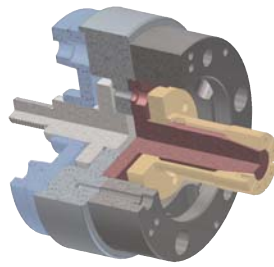

SPECIAL CHUCK

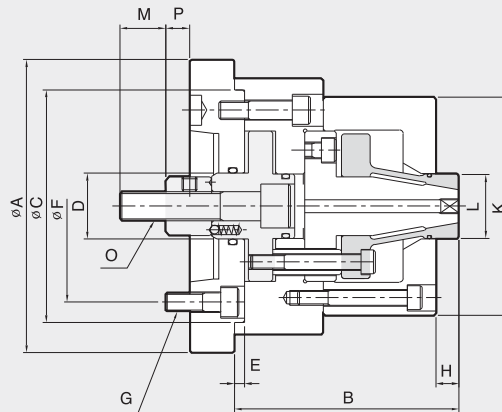
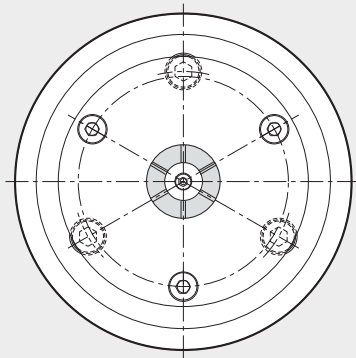

Dimensions

	ΦA	B	$\Phi C(h7)$	ΦD	E	ΦF	G	H	ΦK	$\Phi L_{max.}$	$\Phi L_{min.}$	M	O	P _{max.}	P _{min.}
CDI-06	165	115	150	35	6	104.8	M10	15	L+25	15	40	40	M16	26	23
CDI-08	200	135	170	42	6	133.4	M12	20	L+35	90	40	45	M20	33	29
CDI-10	250	180	230	52	6	171.4	M16	35	L+40	130	90	55	M24	36	32
CDI-12	300	220	230	52	6	171.4	M16	40	L+50	180	130	55	M24	37	32

Specifications

Type	Max. Clamping Force	Max. Drawbar Pull	Collect Expansion	Plunger Stroke	Chucking Dia.		Max. Speed	Weight	GD ²
	[kgf]	[kgf]	[mm]	[mm]	Max.	Min.	[r.p.m.]	[kg]	[kgf·m ²]
CDI-06	4000	1500	0.8	3	40	15	4500	7	0.06
CDI-08	7000	2500	1.0	4	90	40	4000	14	0.19
CDI-10	12000	4000	1.0	4	130	90	3300	34	0.71
CDI-12	15000	4800	1.4	5	180	130	2500	55	2.0