



บล็อก punches แบบมีขา 2 ข้าง ความหนาขา 10 มม. (BLOCK PUNCHES FLANGE THICKNESS 10 mm. - DOUBLE FLANGE TYPE)

STEEL GRADE M HARDNESS H	Catalog No.			 Flange part details The radius is greater than that Of the existing 5 mm. type flange.	 $R=0.8-1.0$	 $10^{+0.2}_0$ $L^{+0.2}_0$ $B^{+0.3}_0$ $\sqrt{1.6}$ G
	Type	B Point length	Shape			
(H2 ~ 5) SKH51 61 ~ 64HRC	AHW		 	 	$W < P \leq W \times 20$ $W \leq P \leq W \times 20$ $R = 0$ Also available $W \leq P \leq W \times 20$ $W \leq P \leq W \times 20$ $0.20 \leq R < W/2$ 0.01 mm. increments	 $2.0-0.1$ $H^{+0.01}_0$ $2.0-0.1$ $2.0-0.1$ $H^{+0.01}_0$ $2.0-0.1$ $2.0-0.1$ $H^{+0.01}_0$ $2.0-0.1$ $2.0-0.1$ $H^{+0.01}_0$ $2.0-0.1$ $V^{+0.01}_0$ $W \leq 0.01$ $R \leq 0.2$ $P \leq 0.01$ $W \leq 0.01$ $R \leq 0.2$ $P \leq 0.01$ $W \leq 0.01$ $R \leq 0.2$ $P \leq 0.01$ $W \leq 0.01$ $R \leq 0.2$ $P \leq 0.01$ $W \leq 0.01$ $R \leq 0.2$
(H6 ~ 13) SKD11 60 ~ 63HRC						
SKH51 61 ~ 64HRC	AHSW (H6~13)					
HAP40 64 ~ 67HRC	APHW					

● In the case of P=V and W=H, the tip tolerance uses P and W tolerances.

Catalog No.			V	3	4	5	6	8	10	13	16	20	22	25	28	30	L	B				
Type	B Point length	Shape																H	Pmin. Wmin.	S	L	
AHW AHSW (H6~13) APHW		 	(2)	1.0	●	●	●	●	●	●								50	6	8		
			(3)	1.0	●	●	●	●	●	●	●	●	●									
			(4)	1.0		●	●	●	●	●	●	●	●	●						60	8	13
			5	1.2		●	●	●	●	●	●	●	●	●	●	●	●	●				
			6	1.5			●	●	●	●	●	●	●	●	●	●	●	●	●	70	8	13
			8	2.0				●	●	●	●	●	●	●	●	●	●	●				
			10	2.5						●	●	●	●	●	●	●	●	●	●	80	13	19
			13	3.0							●	●	●	●	●	●	●	●				

● H (2) (3) (4) ⇒ L50 ~ 70 When the dimension H is (2) (3) or (4), the overall length L is within the range from 50 to 70



The flange position is fixed. (There is no need to specify WF)

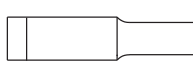

Order

(1) When the point is in the center of shank.

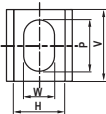

Catalog No. V - H - L - 0.01 mm. increments
P - W - R(E only)
APHWSD 10 - 10 - 60 - P8.00 - W6.00

(2) When the point is not on the center of shank.

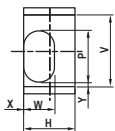

Catalog No. V - H - L - 0.01 mm. increments - 0.01 mm. increments
P - W - R(E only) - X - Y
APHWLD 10 - 10 - 60 - P6.00 - W5.00 - X0.00 - Y0.10

⊗ Designation X · Y
≥ 0.02 mm. Or X · Y = 0
Tolerance ± 0.01