

Economy Box Drawing Information

Model \ Division	H1	H2	H3	H4	W1	W2	W3	W4	D1	D2
EN-1013	129.1	115.6	92.3		99.3	86.8	62.4		50	20
EN-1015	149.4	136.4	112.5		99.3	86.8	62.4		50	20
EN-1020	199.1	185.8	162.6		99.9	86.8	62.4		50	20
EN-1027	269.5	254.4	237.5		99.9	86.2	62.4		50	20
EN-1515	151.5	132.5	121.3	111.2	151.5	132.5	121.3	111.2	70	20
EN-1520	215.5	195.5	179	160	161.5	145.5	129	160	75	25
EN-1818	196	180	163.5	144.5	196	180	163.5	144.5	120	25
EN-2227	275	255	240	210	225	205	189	160	90	30
EN-2030-S	308.5	284	256	229	203	183	154	129.5	102	30
EN-2030	308.5	284	256	229	203	183	154	129.5	132	30
EN-2030-B	308.5	284	256	229	203	183	154	129.5	173	30
EN-2535	356	330	310	271	250	230	210	179	120	30
EN-2535-B	356	330	310	271	250	230	210	179	150	30
EN-3040	410	384.5	357	330	304.5	280	255.5	231.5	132	30.5
EN-3040-B	410	385	357	330	305	280	256	231	150	30
EN-3545-S	450	423	402	365	350	321	302	274	130	30
EN-3545	450	423	402	365	350	321	302	274	170	30
EN-4050	500	478	454	425	400	378	354	339.5	130	30
EN-4050-B	500	478	454	425	400	378	354	339.5	170	30
EN-4353-S	530	500	457	420	430	399	357	328	130	30
EN-4353	530	500	457	420	430	399	357	328	170	30
EN-5060-S	634	599	576	540	534	500	477	444	150	32
EN-5060	634	600	577	540	534	500	477	445	220	32
EN-5070-S	733	699	676	644	533	499	477	444	150	30
EN-5070	734	700	677	645	534	500	477	445	220	30
EN-6080	810	777	760	704	607	574	556	517	257	25

Dimension

(Allowable error: ± 1mm)

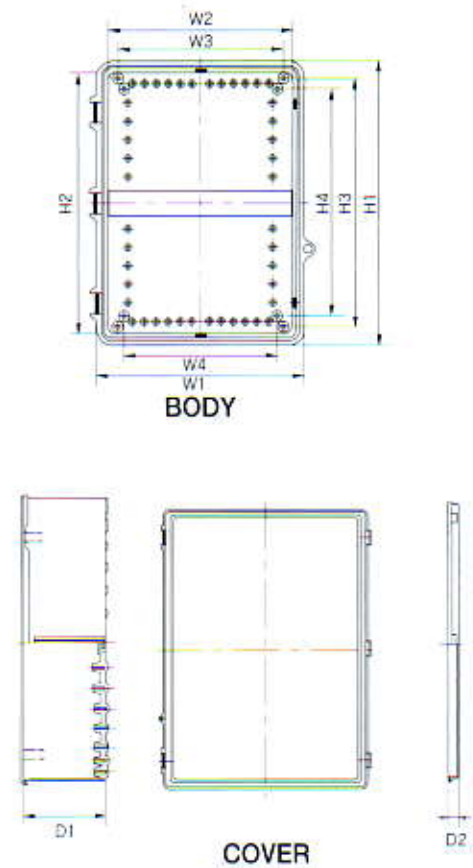

Steel Mounting Panel

Product	mm W×H×D	inch W×H×D	MODEL
DS-000-1013	96.5 X 68 X 1.6	3.80 X 2.68 X 0.06	DS-1013
DS-000-1015	116 X 68 X 1.6	4.57 X 2.68 X 0.06	DS-1015
DS-000-1020	165.5 X 68 X 1.6	6.52 X 2.68 X 0.06	DS-1020
DS-000-1027	235 X 68 X 1.6	9.25 X 2.68 X 0.06	DS-1027
DS-000-1515	124 X 124 X 1.6	4.88 X 4.88 X 0.06	DS-1515
DS-000-1520	186 X 136 X 1.6	7.32 X 5.35 X 0.06	DS-1520
DS-000-2227	251 X 200 X 3.4	9.88 X 7.87 X 0.13	DS-2227
DS-000-2030(-S,-B)	267 X 170 X 1.6	10.51 X 6.69 X 0.06	DS-2030
DS-000-2535(-B)	321 X 221 X 1.6	12.63 X 8.70 X 0.06	DS-2535
DS-000-3040(-B)	362 X 265 X 1.6	14.25 X 10.43 X 0.06	DS-3040
DS-000-4050	463 X 362 X 1.6	18.23 X 14.25 X 0.06	DS-4050
DS-000-3545(-S)	420 X 307 X 1.6	16.54 X 12.09 X 0.06	DS-3545
DS-000-4353(-S)	463 X 362 X 1.6	18.22 X 14.25 X 0.06	DS-4353
DS-000-5060(-S)	485 X 575 X 1.6	18.31 X 22.64 X 0.06	DS-5060
DS-000-5070(-S)	680 X 480 X 1.6	26.77 X 18.90 X 0.06	DS-5070
DS-000-6080	720 X 520 X 1.6	28.35 X 20.47 X 0.06	DS-6080

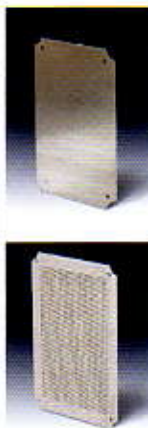

Plastic Mounting Panel

Product	mm W×H×D	inch W×H×D	MODEL
DS-000-1013	96.5 X 68 X 3.5	3.80 X 2.68 X 0.14	DS-1013 P/L
DS-000-1015	116 X 68 X 3.5	4.57 X 2.68 X 0.14	DS-1015 P/L
DS-000-1020	165.5 X 68 X 3.5	6.52 X 2.68 X 0.14	DS-1020 P/L
DS-000-1027	235 X 68 X 3.5	9.25 X 2.68 X 0.14	DS-1027 P/L
DS-000-1515	124 X 124 X 3.75	4.88 X 4.88 X 0.15	DS-1515 P/L
DS-000-1520	186 X 136 X 3.0	7.32 X 5.35 X 0.12	DS-1520 P/L
DS-000-1818	175 X 175 X 4.1	6.89 X 6.89 X 0.16	DS-1818 P/L
DS-000-2227	251 X 200 X 3.4	9.88 X 7.87 X 0.13	DS-2227 P/L
DS-000-2030(-S,-B)	267 X 170 X 3.4	10.51 X 6.69 X 0.13	DS-2030 P/L
DS-000-2535(-B)	316 X 217 X 4.3	12.44 X 8.54 X 0.17	DS-2535 P/L
DS-000-3040(-B)	362 X 265 X 3.4	14.25 X 10.43 X 0.15	DS-3040 P/L
DS-000-4050	463 X 362 X 4.3	18.23 X 14.25 X 0.17	DS-4050 P/L
DS-000-3545(-S)	420 X 307 X 4.3	16.54 X 12.09 X 0.17	DS-3545 P/L
DS-000-4353(-S)	463 X 362 X 4.3	18.23 X 14.25 X 0.17	DS-4353 P/L